

FLOORS INSULATION  
WITH HOT WATER UNDERFLOOR HEATING SYSTEMS  
AND UNDER SCREED

**TRISO-SOLS MULTIFOIL INSULATION**

**ACTIS**

TOMORROW'S INSULATION TODAY

# INSULATION OF FLOORS WITH HOT WATER UNDERFLOOR HEATING SYSTEMS AND UNDER SCREED

## PRODUCT BENEFITS

- Ideal for renovation: preserves headroom (only 6.5mm thick).
- Uniformly reflects the heat from hot water underfloor heating systems back up into the room.
- Eliminates thermal bridging at floor perimeters, no need for separate edge strips.
- Polythene film with grid markings facilitates laying of heating pipes.

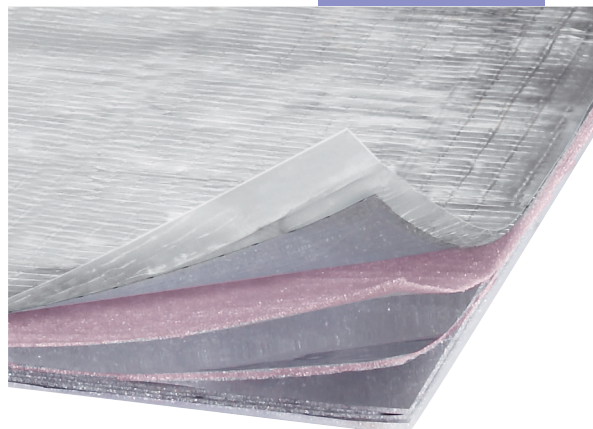

## ADVANTAGES

- Space saving.
- Clean and free from irritant fibres.
- Durable
- Quick and easy to install: flexible, can be cut with scissors or Actis cutter.
- Light, easy to transport.



## TECHNICAL CHARACTERISTICS

13 components:

- 2 reflective films
- 4 internal reflective foils
- 6 foam layers
- 1 polythene film

Number of reflective foils: 6  
Thickness: 6,5mm.

PROPERTIES	VALUE	REFERENCE STANDARD
<b>Acoustic Insulation</b>		
Insulation against impact noise	$\Delta L = 21 \text{ dB}$	
<b>Mechanical Resistance</b>		
Tensile strength:		
Longitudinal force	$\geq 500 \text{ N/50mm}$	EN 12311-1
Transversal force		$\geq 400 \text{ N/50mm}$
Nail tear resistance		
Longitudinal	$\geq 200 \text{ N}$	EN 12310-1
Transversal	$\geq 300 \text{ N}$	
<b>PACKAGING</b>		20 m <sup>2</sup> (roll)
Width	1,60m	
Length	12,50m	
Weight (per roll approx.)	10kg.	

# FLOORS WITH HOT WATER UNDERFLOOR HEATING SYSTEMS

## PREPARATION

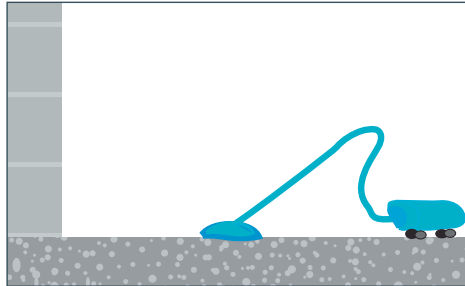

- Prepare the floor by ensuring that is clean, dry and even.

## LAYING THE FIRST STRIP

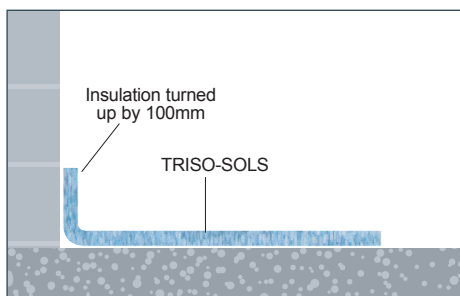

- Roll the insulation out on the floor.
- Turn the insulation up at the walls by 100 to 150mm to insulate floor edges.

## LAYING THE FOLLOWING STRIPS

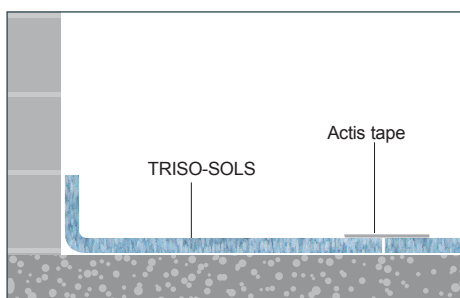

- Do not overlap the two strips of insulation, instead butt the second strip up against the first. Only the polythene film should overlap.

## FINISH

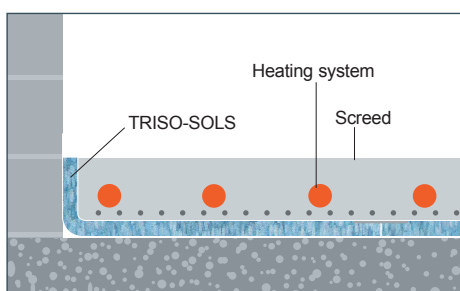

- Fit the hot water underfloor heating system and screed to manufacturers' specifications and in accordance with the relevant regulations.



# INSTALLATION GUIDE AND RECOMMENDATIONS

## INSTALLATION UNDER A SCREED

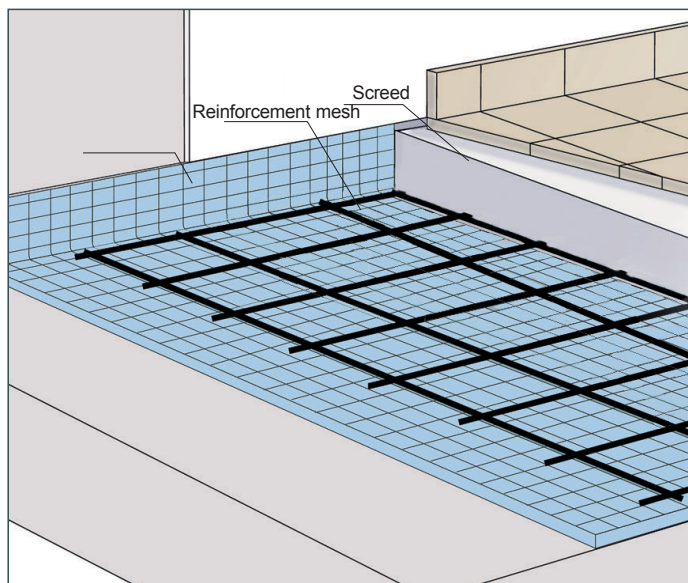

- TRISO-SOLS can be used under a screed, with or without hot water underfloor heating, either on its own or laid over another insulation product.
- TRISO-SOLS can be used to insulate against impact noise.

## ACCESSORIES



Actis Cutter



Actis Tape

## SAFETY PRECAUTIONS

TRISO-SOLS should be installed and used in compliance with good building practice; the most recent editions of any applicable regulations or relevant guidance and any British or European Standards relating to the installation and use of insulation products, particularly in relation to safety precautions.

### Fire precautions

Never expose Actis insulation to a direct heat source, sparks or a naked flame. Keep blow torches well away from Actis insulation, even when using a flame guard or other protective device, and make sure that hot debris and sparks do not make contact with the insulation.

### Fireproof finishes and compartment walls

As recommended by current regulatory guidance, do not leave insulation exposed in habitable rooms. We recommend that Actis insulation is always covered with a fireproof finish such as plasterboard (see, for example, the fire safety provisions contained in Approved Document B, which provides practical guidance on the fire safety requirements of the Building Regulations 2000 (as amended) in England and Wales; or refer to the relevant provisions in Scotland and Northern Ireland, as amended from time to time).

### Chimneys, flues, heat exchangers and other sources of heat

Never use Actis insulation to insulate a chimney flue, heat exchanger or any other heat source above 80°C. Use a Euroclass A1 non-combustible insulation in compliance with British or European Standards. Actis advise leaving a minimum gap of 200 mm between the insulation and chimneys, flues, heat exchangers and all other sources of heat above 80°C.

### Contact between materials

Avoid all contact between Actis products and lead, zinc, copper and its alloys as well as caustic products.

### General guidance on installing TRISO-SOLS

Insulation should take into account all elements of the building envelope which are susceptible to thermal losses, such as doors, windows, roofs, chimneys, walls and floors. Adequate ventilation should be provided where necessary, in compliance with good building practice and with the most recent editions of the relevant regulatory guidance and British and European Standards available. Actis cannot compensate for heat losses due to defective or poorly insulated joinery, or thermal bridging due to poor construction. Actis makes no warranty, express or implied, as to the performance of its products if the relevant installation guidelines are not followed.

### Protecting your Actis product from the elements before and after installation

TRISO-SOLS should be stored in its packaging under cover to protect it from the elements (such as rain or snow). During installation, Actis product should be protected from any prolonged exposure to rain or snow. Once installed, the product should not be left exposed to weathering for more than 3 days.

Entreprise certifiée :

ISO 9001

BUREAU VERITAS  
Certification

N°175477



## ACTIS INSULATION Ltd

Unit 1 Cornbrash Park - Bumpers Way  
Bumpers Farm Industrial Estate  
Chippenham - Whilshire - SN14 6RA  
Tel. +44 (0) 1249 462 888  
Email: solutions@insulation-actis.com

[www.insulation-actis.com](http://www.insulation-actis.com)